

---

# Highway Gardens



## Space Features

**Facility Description:** Outside space

**Electrical:** None

**Restrooms:** No

## Highway Gardens Rental Guidelines

### What's Included

- Rental includes outdoor garden space only.
- The MO-DOT building located within the gardens is not available for rental or use.

### About the Gardens

- Flowers and plants are timed to look their best for the Missouri State Fair in August.
- Planting typically begins in June, so early-summer events may see limited blooms.

### Setup and Cleanup

- Renters are responsible for setting up and returning tables and chairs to where found.
- Picnic tables must remain in their designated locations.
- All trash must be placed in the provided barrels before leaving.

### Garden Protection

- To protect the underground sprinkler system, no vehicles may enter the gardens.
- No digging, staking, planting, or breaking ground is allowed.
- No pools, sprinklers, or water play are permitted.

### Petal Toss Policy

- Real flower petals are encouraged.
- If silk petals are used, gather all petals afterward to avoid extra cleaning charges.

### Restrooms

- The closest restrooms are located north of the Beef House and are available April 1–October 31, weather permitting.
- If freezing temperatures are forecast, restrooms may be temporarily closed.

Looking for an outdoor space for your ceremony? The Highway Gardens is the perfect choice. This hidden gem, built in the 1920s, offers an intimate atmosphere surrounded by lush greenery during the summer months, creating a beautiful natural backdrop for photos. Maintained by the Missouri Department of Transportation, the gardens serve as a tribute to the many roadside parks found alongside Missouri's highways, adding charm and history to your celebration.

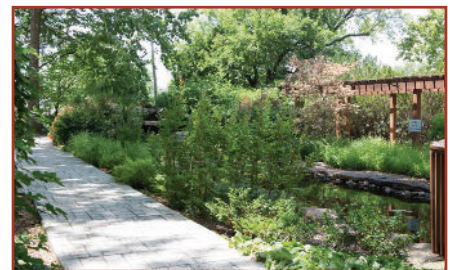
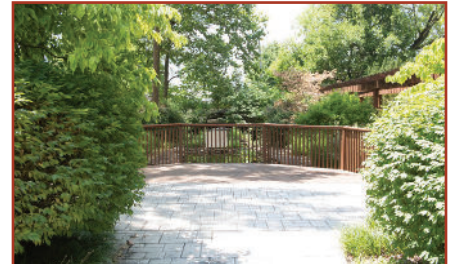

Prices are subject to change without notice. For accessibility details, visit <https://mostatefairgrounds.com/plan-event/accessibility/>.